

REVISIONS			
REV	DESCRIPTION	DATE	APPROVED

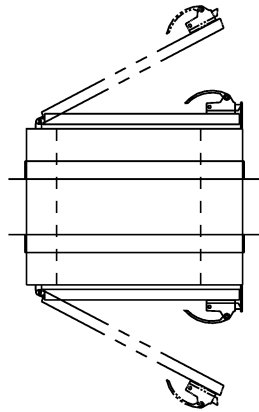

PLAN VIEW

NOTES:

- UNIT FABRICATION TO BE DOUBLE WALL, CONSTRUCTION
- UNIT TO BE CONSTRUCTED OF 16 & 20 GA. 304 STAINLESS STEEL WITH #4 FINISH
- DOORS TO BE CONSTRUCTED OF 16 GA. 304 STAINLESS STEEL WITH 1/4" THK. CLEAR ACRYLIC GLAZING, SS PIN HINGES AND STAINLESS STEEL LATCHING HANDLE
- UNIT TO BE SUPPLIED WITH 1 1/2" X 1 1/2" X 16 GA. 304 STAINLESS STEEL ONE PIECE WELDED FINISHING TRIMS (TO BE FIELD INSTALLED)
- UNIT TO HAVE A MECHANICAL DOOR INTERLOCK SYSTEM
- ROUGH OPENING TO BE 1/4" LARGER THAN OUTSIDE DIMENSIONS OF UNIT

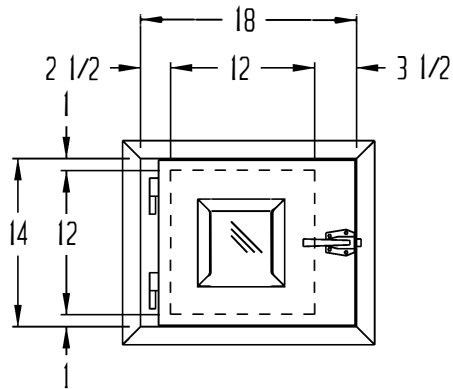

FRONT VIEW

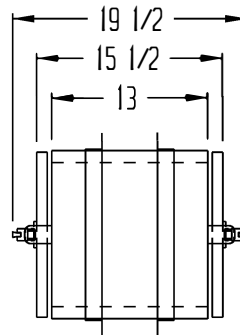

SIDE VIEW

1 UNIT REQUIRED AS SHOWN

DRAWN FOR		HALCO PRODUCTS CO.		
		100 NO. GORDON STREET ELK GROVE, IL. 60007		
DRAWN BY DK		TITLE PT1212-13/SS/MI		
		SIZE	JOB NO. 13719	DWG NO. 1518983A0
APPROVED BY		SCALE 5/8"=1'	DATE 11/21/15	SHEET